

TRUMPF | TITAN

The operating table for extreme
Requirements

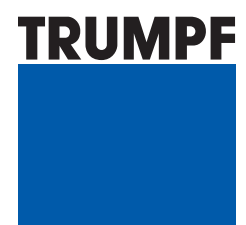

INNOVATIONS FOR PATIENT CARE



Extremely strong, easy to move and fit for every surgical speciality – the new operating table from TRUMPF

Ideal equipment for the operating theatre of tomorrow.

TITAN, the mobile operating table for universal surgical applications, leaves nothing to be desired. Hardly any other table can offer so much comfort and cost-effectiveness rolled into one. TITAN's modular accessory system can be extended at any time and combined to a virtually unlimited extent. Its unique coupling system is almost entirely resistant to wear. Stainless steel, laser-aided processing and disinfectant-resistant pads make the TITAN the perfect investment in the future.

Extreme stability

for loads up to 450 kg

Electric motor-driven movement functions

make the transportation and positioning of patients easier

Modular design

guarantees cost-effectiveness both now and in the future

Wide ranges of adjustment

for column and table top

Maximum room for the feet

ensures an ergonomic work position

Ideal radiolucence

thanks to design without transverse struts and optional carbon segments

Intelligent accessories

for all applications

User-friendly operation

manual and remote control





The TITAN offers a load capacity up to 450 kg yet can still be moved easily – thanks to the support of electric motors

Extreme manoeuvrability despite high weight.

The strong TITAN is designed for especially heavy patients and sets new standards with its functionality. Electric motor-driven joints, precise adjustment and individually programmable remote control make the work of the entire operating team easier. With its modular accessory system it offers surgeons a complete range of options – including for the treatment of normal-weight patients.

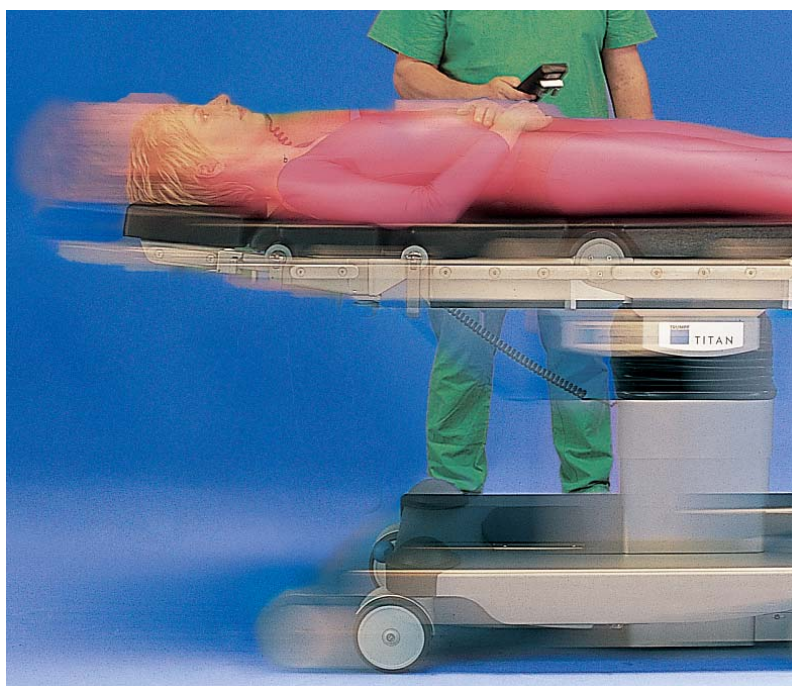

Moves (almost) by itself.

The motor-driven running gear does the heaviest work during the transportation of patients. An additional lowering wheel assists movement of the table, ensuring that it runs straight. But during the entire operation the TITAN has a rock-solid position – standing on four electric motor-driven extendable feet.

Despite its weight catering for extreme loads the TITAN is safe and easy to move. The optimum work procedure in the operating theatre is aided by intelligent details.

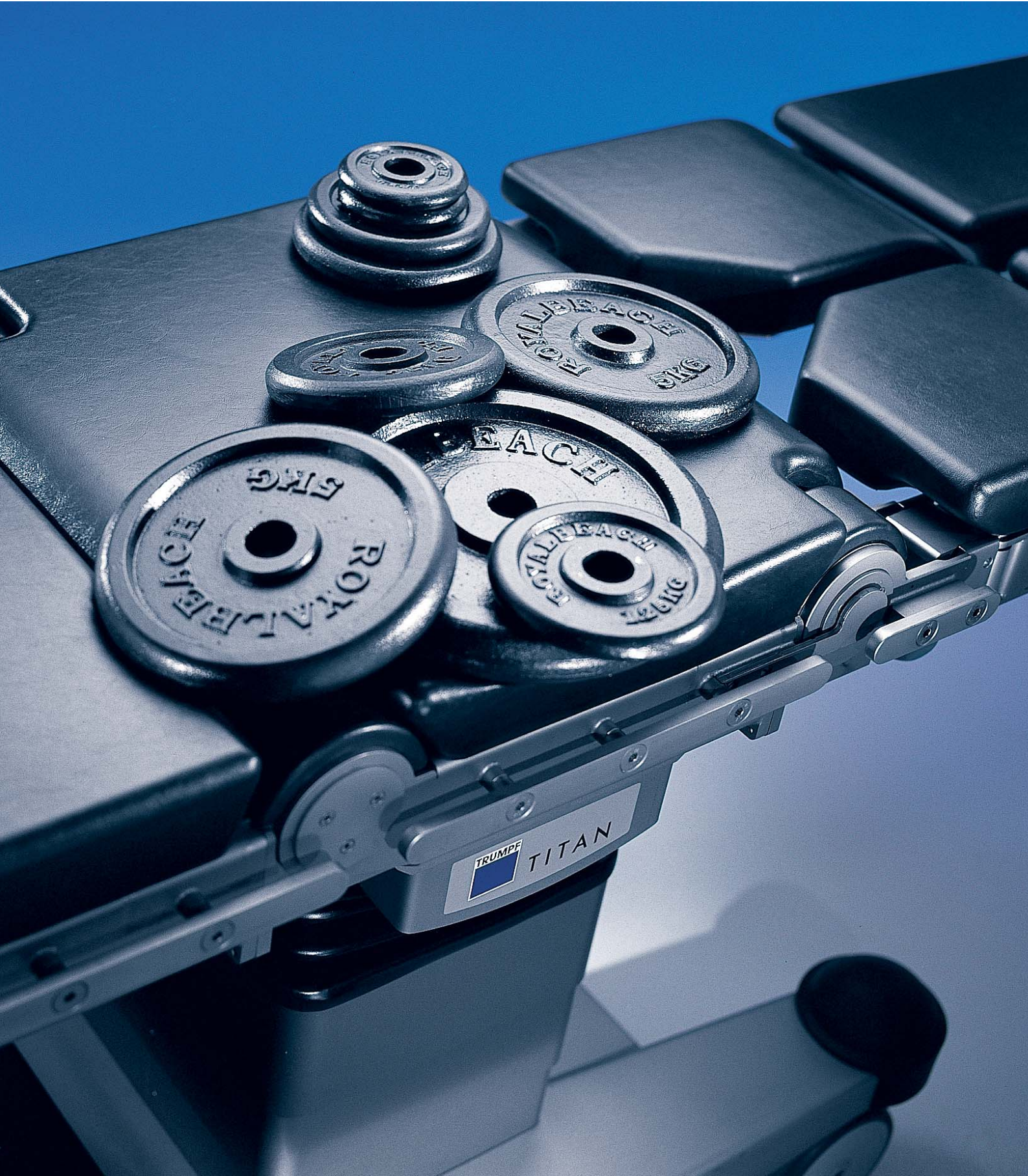

Flexibility today, extendability tomorrow – with the modular component system you are assured cost-effective operation both now and in the future

Freely selectable table top combinations.

The basic equipment of the TITAN only includes a seat section and lower back section – you choose everything else according to your requirements. The individual modules supplement each other and can be combined to a virtually unlimited extent. This allows you to put together an operating table for your very own needs, so cutting down on unnecessary extra expense.

Intelligent modules for greater safety.

The coupling points between the individual table tops are mechanically coded. This prevents impermissible combinations being made when configuring the table top. To help with motorised positioning a signal sounds as soon as the 0-position of the moved worktop is reached.

Additional comfort functions.

The simple reverse orientation of the table (head section coupled to seat section) provides for motorised movement of the head section. All operating units detect the reverse design as soon as the head side is specified at the operating panel of the table. Specially developed by TRUMPF: the electric interface for extension modules. It provides for the motorised adjustment of docked additional parts via remote control.

Operating units as required.

You can select the operating units for the TITAN according to your individual preferences and physical requirements: cable remote control, infrared remote control or wall-mounted control panel. The column keypad is based on the principle of two-finger safety operation. The foot control can be used to activate two freely selectable functions, for example the height lift and Trendelenburg.



1

1. Optimum adaptability to patients of all sizes.



2

2. Electric motor-driven seat section extension for urology.



3

3. Reverse orientation of table top allows motorised head section adjustment.



4

4. Ophthalmology adapter with electric motor-driven head rest adjustment.

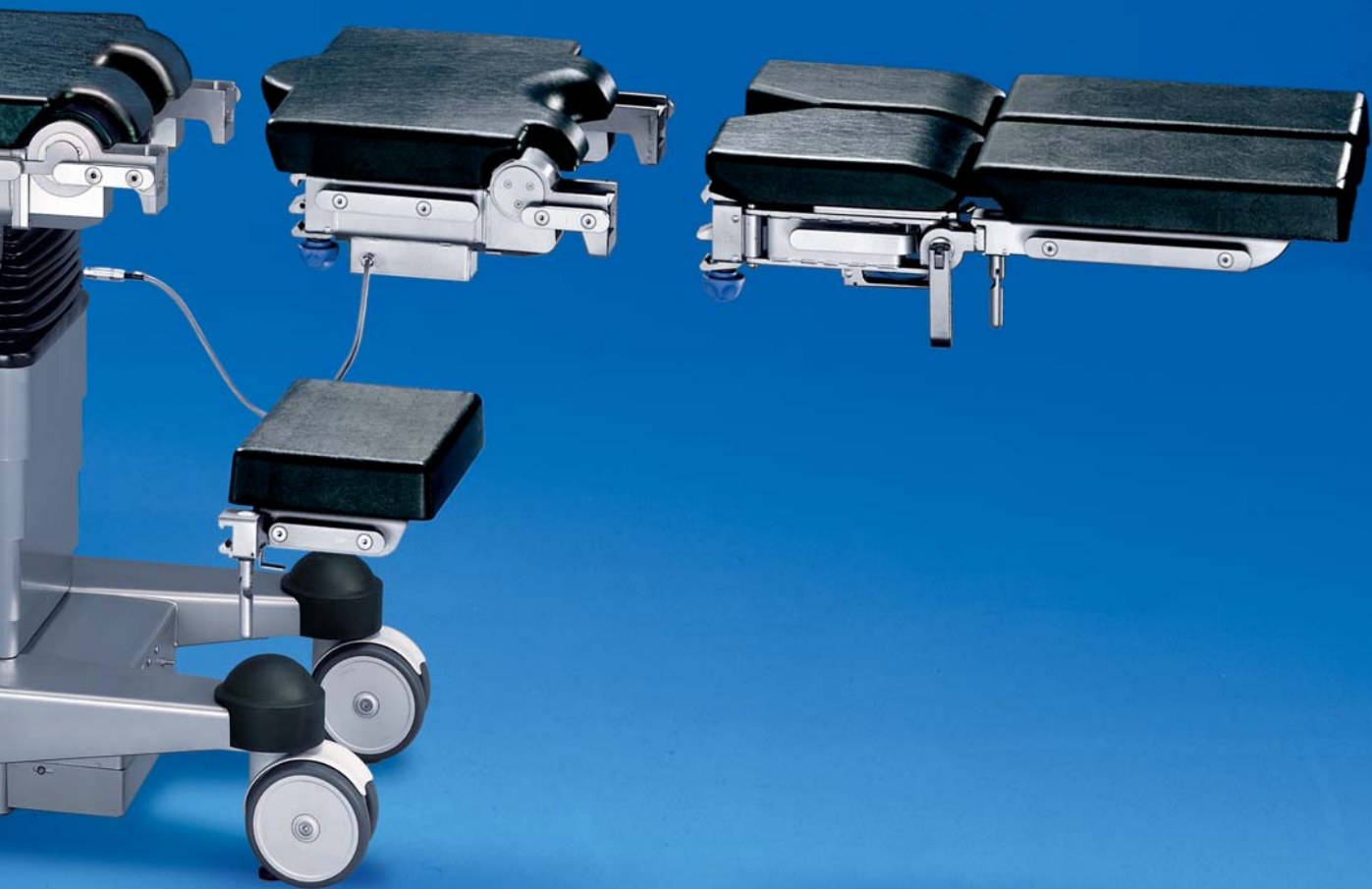

5. Flexible arm and leg extension units for use in orthopaedics and traumatology.



6. Optimised access to the operating area due to extreme spread of leg sections.



7. Longitudinal adjustment for precise positioning under the C-shaped frame.



8. Carbon segments for 360° radiolucence and extensive longitudinal adjustment for precise positioning under the C-shaped frame.



Convenient operation and precise workmanship lighten the workload with TITAN



Strength and lightness rolled into one.

The joints, lifting mechanism and brackets of the TITAN remain fully functional even with the heaviest of loads. Electric motor-driven adjustment is possible not only of the height, lateral tilting and Trendelenburg but also the dockable leg sections, longitudinal adjustment and the back section.

User-friendly thanks to maximum flexibility.

Large angle of adjustment, steep slopes and extreme high-/low-level positions make work more pleasant for the surgeon and operating team. The raised cladding of the running gear also offers room for the feet to an unprecedented degree.

Precise mechanics – easy to care for materials.

The unique coupling points between the table tops function according to the retaining principle of the standard rail and thus makes the design of the table more simple. The soft, detachable pads are just as easy to clean as the stainless steel frame.

Computer-aided efficiency for maintenance and service.

For program adaptation and fault diagnosis we can offer you our special software. Combined with modem-aided remote diagnosis from TRUMPF Service problems can often be solved immediately. Or our technician will come to you thoroughly prepared and with the right tools.



1



2



3



4

1. Motorised head section adjustment by reverse orientation of the table top.

2. Joint with soft cover – easy to clean like all pads.

3. Flex and reflex positions are selected at the touch of a button.

4. Computer-assisted service and remote diagnosis via modem connection.

Precise adjustment, secure fixing, variable design

Positioning is an art in itself.

Exact positioning of the patient forms the basis for an optimum work flow and surgical success. It may even be necessary to change position during the intervention, in induction and recovery. The right equipment backs up the team in their work – and even optimises it in an ideal case.

The right accessory is a decisive factor.

It is up to you whether you require individual accessories or prefer to use the recommended basic equipment for your surgical speciality. At all events you can be sure of creating an ergonomically practical workstation – with items that will pay off over the years.

The positioning accessories for the TITAN have proved their worth in day-to-day usage. They undergo continuous improvement in direct consultation with users. The skilled workmanship and optimum materials guarantee top quality:

- toothed joints for exact and reliable positioning – even after many years of use
- ergonomically shaped screw handles
- precisely worked connections
- low-maintenance technology, easy to care for materials
- special equipment for all applications
- absolute stability and steadiness
- peripheral accessories such as positioning pads, waste bowls, equipment holders etc.





General surgery

Extensive manoeuvrability in all joints –
flex position at the touch of a button



Gastric Banding.

Reflex and flex positioning is carried out via remote control at the touch of a button. For the fast and safe positioning of patients.



1. Endoscopic inguinal hernia

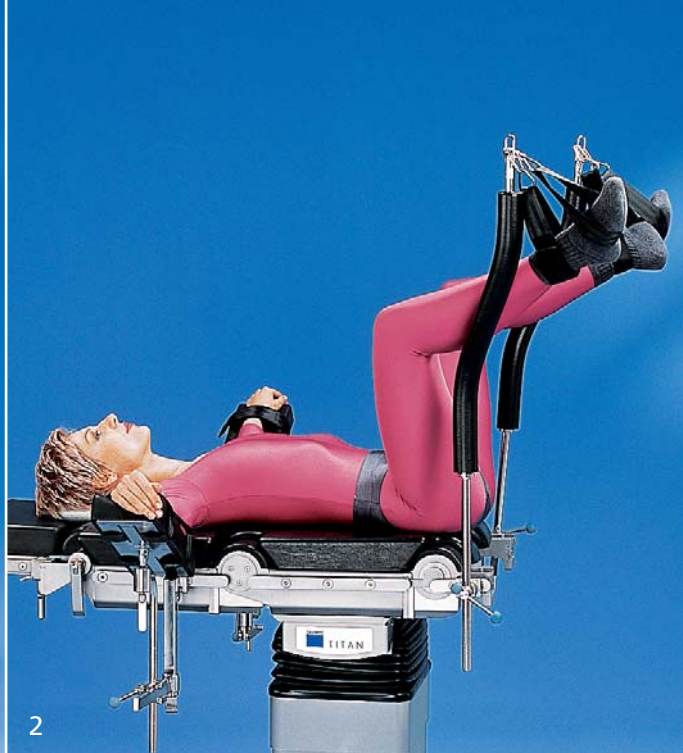

2. Proctological operations



3.14. Abdomino-sacral rectum amputation using the Legmaster for convenient repositioning



5. Lateral thorax position



6. Struma positioning

Gynaecology and urology Versatile seat section extension – optimal access to the operating area



Caesarean position.

The wide spread angle of the leg sections and the raised running gear cladding offer ideal space conditions around the operating area. For fast access including in emergencies.



1



2

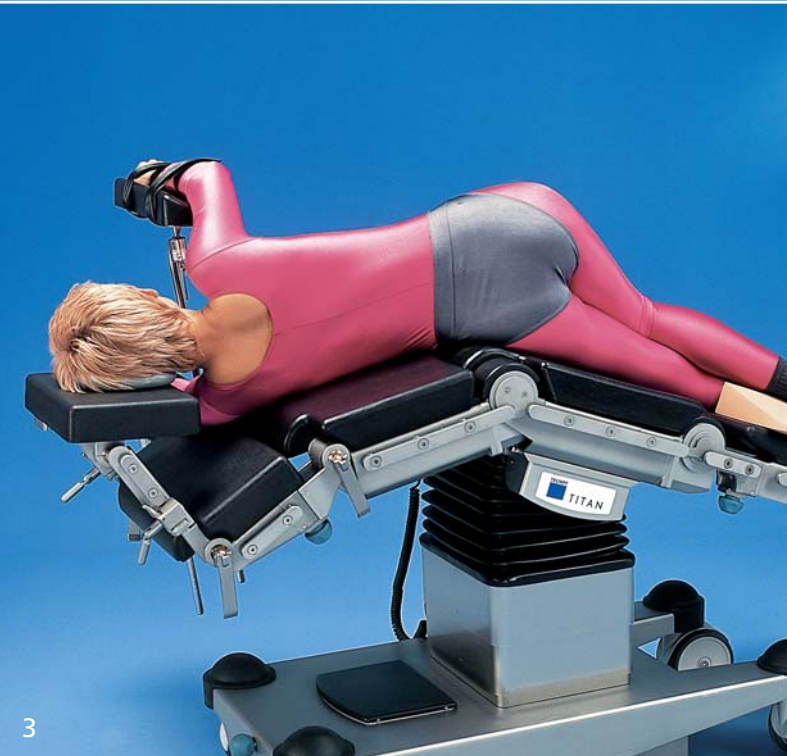

3

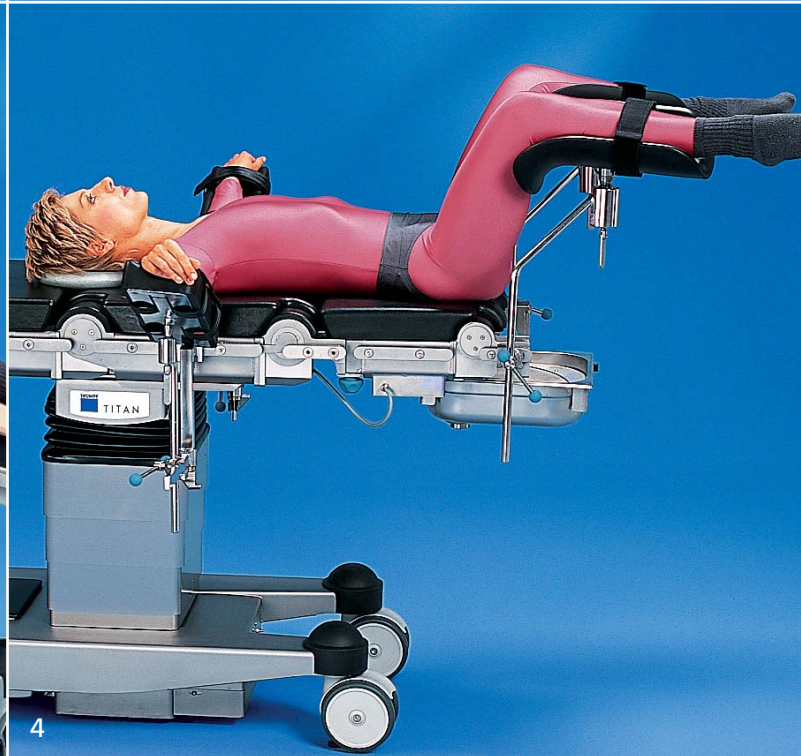

4

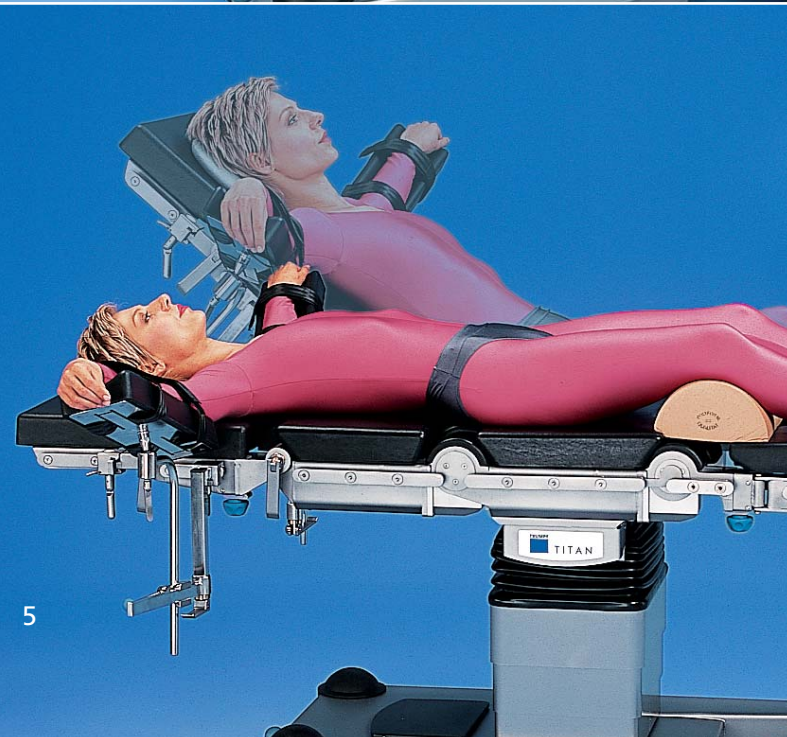

5

1. *Lithotomy position*

2. *Lithotomy position*

3. *Renal positioning*

4. *Urology*

5. *Mammoplastic surgery
(semi-seated)*

Extensions

Extension units for all interventions – special adapter as coupling point



Tibia extension.

The extension accessories are clearly structured and more or less self-explanatory. For the fast and safe creation of individual positions.



1. Femoral extension in a supine position

2. Tibia extension

Traumatology and orthopaedics Extensive accessories – large X-ray area



Shoulder operation.

The shoulder adapter offering free access to the operating area includes a wide range of attachments and additional pads. For user-friendly optimisation of positioning.



1



2



3



4



5

1. Lower arm extension

2. Arthroscopy

3. Hand surgery

4. Prone upper arm positioning

5. Hand surgery with hand operating table

Cardiovascular surgery Large longitudinal adjustment range – 360° radiolucence



Varicectomy.

The generous amount of space means that several persons can work in parallel. Safely and efficiently.



1. Vascular surgery with 3-part table top segment Carbon



2. Cardiosurgery



3. Vascular surgery

Neurosurgery

Ideal working height also when sitting down – individual skull clamp systems



Craniotomy semi-seated.

The fine adjustment of joints and perfect interaction of the entire mechanics ensures reliable patient positioning. For long and complicated operations.

1. Craniotomy in the prone position



1

2. Craniotomy in a supine position



2

3. Extreme positions are also possible. For example: spine positioning for a patient weighing 160 kg.



3

Ophthalmology and ENT Motorised head section adjustment – extensive high and low-level adjustment

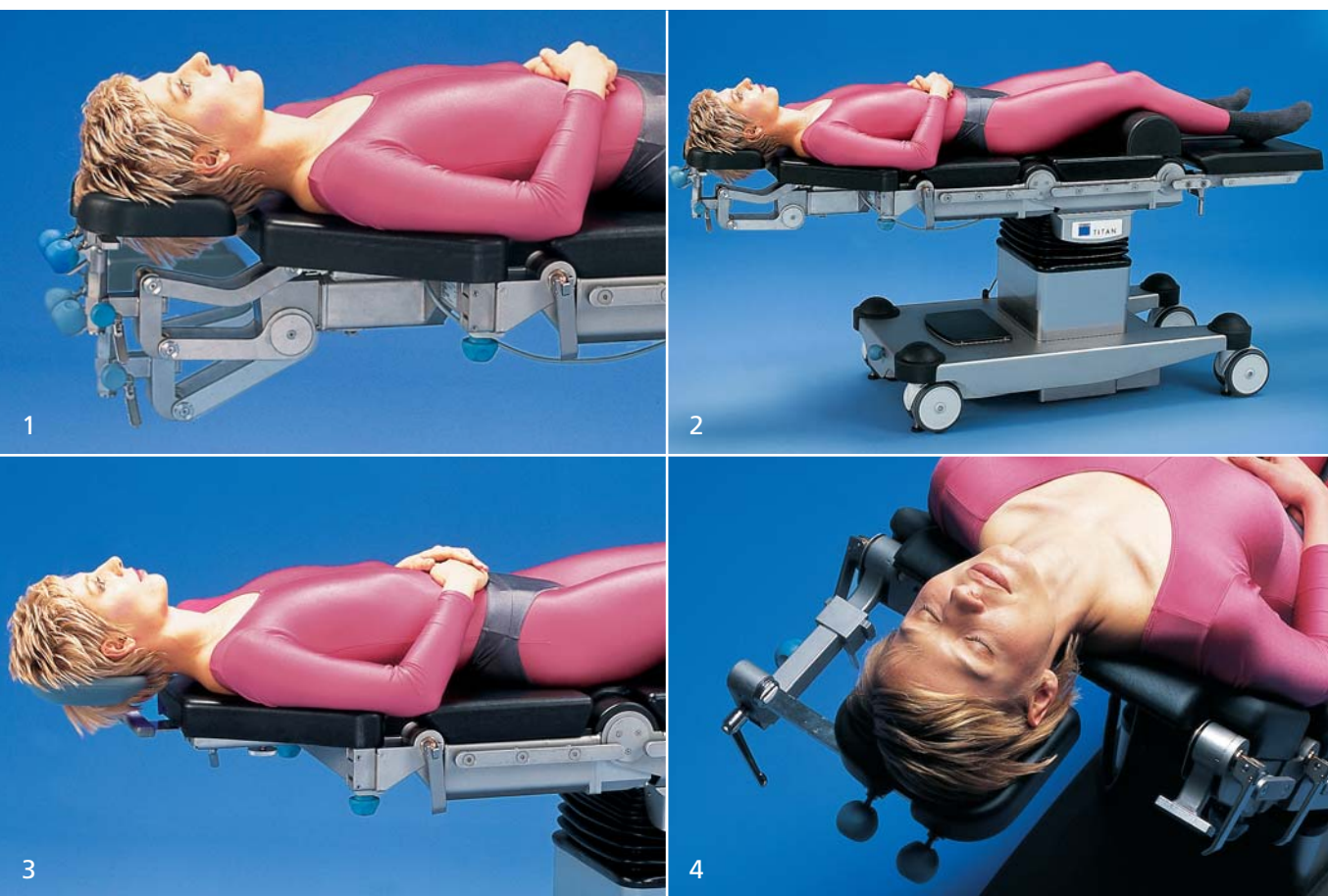

Head rest system with motorised adapter.

The head section can be adjusted easily and accurately due to the electric motor-driven joint. To ensure that the sensitive head area is moved gently and safely.

1. *Progressively adjustable head rest*
2. *Ophthalmology adapter with motorised head rest adjustment*
3. *Ophthalmology adapter*
4. *Head rest system*

Extreme, manual and motorised ranges of adjustment



The extreme ranges of adjustment in both the manual and motorised sector make the TITAN stand out from the rest:

- height adjustment 630 mm to 1,130 mm
- $\pm 40^\circ$ Trendelenburg/ Anti-Trendelenburg
- $\pm 25^\circ$ lateral tilting

Flex or reflex position

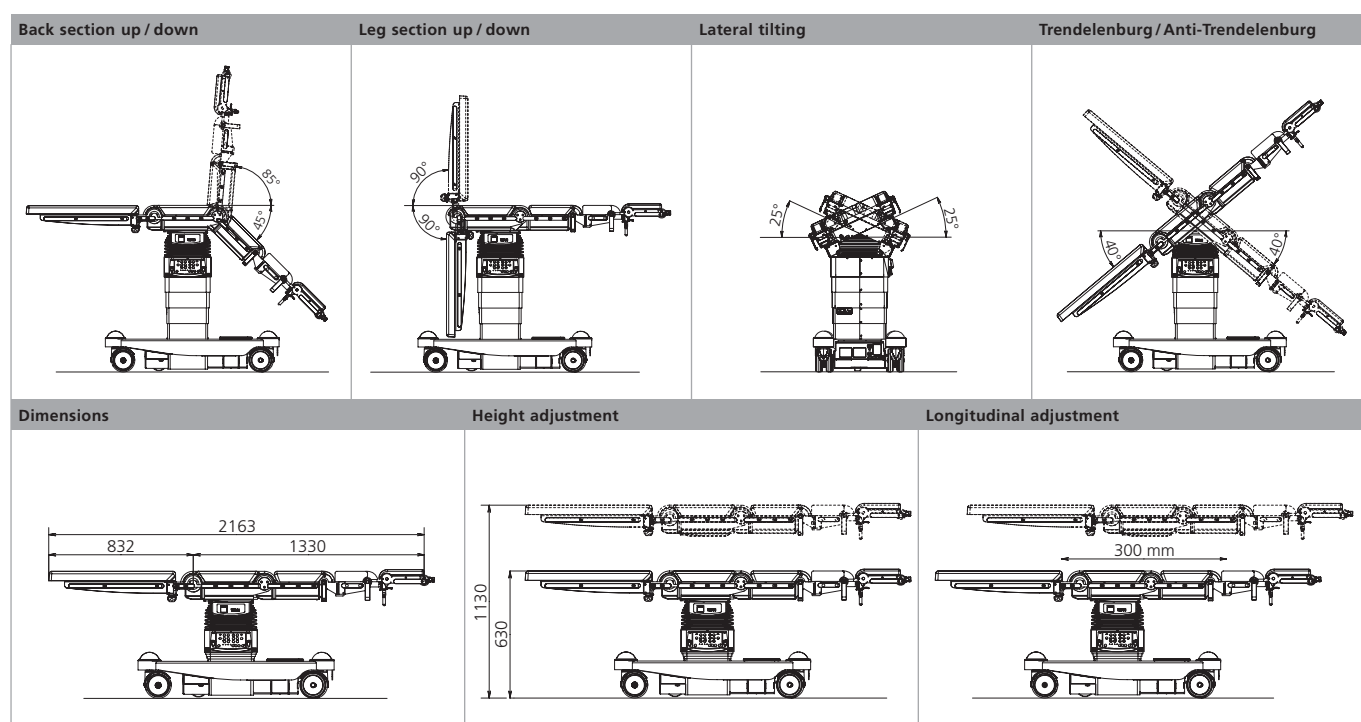

Technical details

TITAN

Material No. 4544260

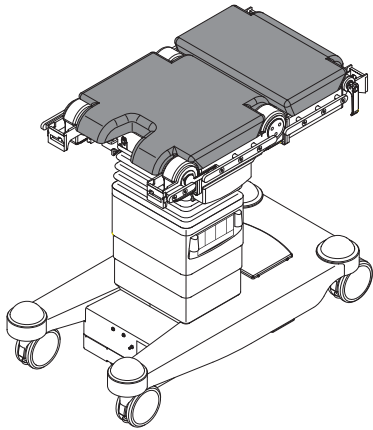

Mobile heavy-load OR table for patient weights up to 450 kg with electromechanical table adjustment and motor-driven chassis; table top base consisting of seat section and lower back section can be adjusted or extended for any surgical requirements by individual combination with mechanical modular components (upper back section, several types of head and leg section, extension accessory, shoulder adaptor, seat section extension, positioning module for head disciplines) or actively driven modular components (electric seat section extension, motor-driven head rest system). Control, including optional actively driven modular components, either via infra-red remote control, cable remote control or via the additional key-pad flush integrated into the column covering; The maintenance-free batteries integrated in the column are charged through a built-in changeover power supply unit; Detachable, integral foam and electrically conductive pad; stable Y-shaped chassis provides plenty of space for the surgeon's feet.; 4 double-jointed casters and an additional lowerable guide wheel guarantee good maneuvering; Table top frame, column covering, coupling points, standard rails and chassis frame made of disinfectant-resistant, easy-to-clean stainless steel.

Technical Data

Drives	motor-driven
Height adjustment	630 mm – 1,130 mm
Longitudinal adjustment	300 mm
Trendelenburg / Anti-Trendelenburg	± 40°
Tilting	± 25°
Leg sections up / down	± 90°
Lower back section up / down	+ 85° / - 45°
Weight	300 kg
Maximum patient weight	450 kg

Upper back section

Material No. 4549101

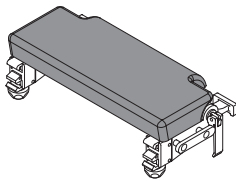

Modular component with manually adjustable joint pair; completely X-ray capable without metal cross-bars between the spars; Integral foam, electrically conductive, soft and detachable pad; load-bearing design, coupling points and standard rails made of disinfectant-resistant, easy-to-clean stainless steel.

Technical Data

Length	225 mm
Width including side rails	580 mm
Adjustment range of joint pair	+ 90° / - 60°

Seat section extension TITAN

Material No. 1268088

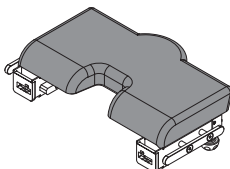

For linking to TRUMPF standard coupling points of the OR table; with mounting rails for X-ray cassettes; integral foam pad Comfort Plus, electrically conductive, soft and removable; load-bearing design made of disinfectant-resistant, easy-to-clean stainless steel.

Technical Data

Extension	250 mm
-----------	--------

Seat section extension, motor-driven

Material No. 4544102

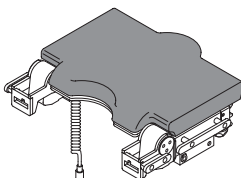

For linking to TRUMPF standard coupling points of the OR table with electric bus system; with integrated mounting rails for X-ray cassettes; with motor-adjustable leg section joints; control via remote control of the OR table system; electric connection to table top by cable; Integral foam, electrically conductive, soft and detachable pad; load-bearing design made of disinfectant-resistant, easy-to-clean stainless steel.

Technical Data

Extension	360 mm
-----------	--------

OR extension TITAN V.1 / OR extension TITAN V.2

Material No. 1287288 / 1287351

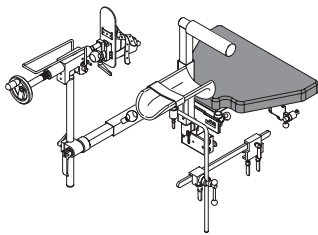
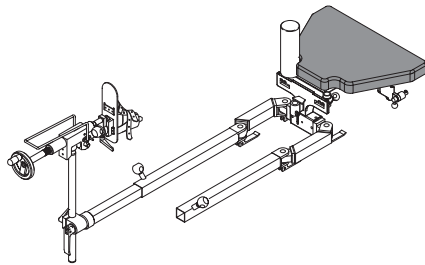

Flexible and modular extension unit for orthopaedics and traumatology; correct positioning for patients of any body sizes; available in two basic configurations, which may be extended individually with numerous additional accessories, if required; adaptor, double joint extension spars, spindle traction mechanisms as well as the bearing design of any accessories are made of disinfectant-resistant, easy-to-clean stainless steel.

	OR extension TITAN V.1		OR extension TITAN V.2	
	Equipment		Equipment	
OR adaptor JUPITER / TITAN	1 piece	1259051	1 piece	1259051
Support pad TITAN	1 piece	1259601	1 piece	1259601
Counter traction rod 80	1 piece	4544449	1 piece	4544449
Double joint spar	1 pair	4544466	1 pair	4544466
Telescopic spar	1 piece	1218831	2 pieces	1218831
Spindle traction mechanism	1 piece	1218832	2 pieces	1218832
Leather sandal for extension right	1 piece	1232546	1 piece	1232546
Leather sandal for extension left			1 piece	4544790
Standard rail mounting	1 piece	4544165	1 piece	4544165
Standard rail	1 piece	4544166	1 piece	4544166
Lower leg counter traction			1 piece	4544770
Telescopic spar short			1 piece	4544771
Counter traction rod 60			1 piece	4544453
Leg holder according to Goepel			1 piece	4544736
Radial clamp			1 piece	1218804

Head section 530 double joint

Material No. 4549601

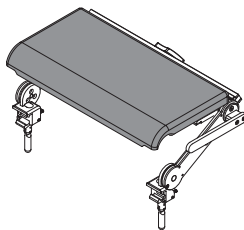

For linking to TRUMPF standard coupling points of the OR table; with double joint and one-hand operation; integral foam Comfort Plus pad, electrically conductive, soft and detachable; Velcro pad attachment; standard rails at the side and at the front of the table; frame made of disinfectant-resistant, easy-to-clean stainless steel.

Technical Data

Length	320 mm
Width	580 mm (NS/NS)
Pad L x W	260 mm x 520 mm
Adjustment range of front joint	± 60°
Adjustment range of back joint	± 60°

Base holder, motor-driven

Material No. 4549525

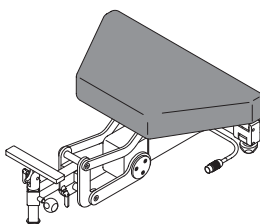

For linking to TRUMPF standard coupling points of the OR table with electric bus system; with connection holder for TRUMPF head rest system; sensor-controlled, motor-driven adjustment of the connection holder; manual adjustment of the head rest at the connection holder; integral foam Comfort Plus pad, electrically conductive and soft; structure made of disinfectant-resistant, easy-to-clean stainless steel.

Technical Data

Dimension	600 mm x 530 mm
Adjustment of connection holder	+ 90 mm / - 70 mm
Longitudinal adjustment of head rest	± 30 mm
Height adjustment of head rest	± 28 mm
Tilting backwards of head rest	approx. 45°

Widening segments TITAN

Material No. 1251205

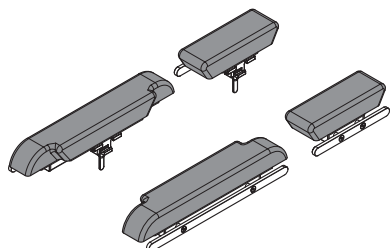

Integral foam, electrically conductive, soft and detachable pad; bearing design made of disinfectant-resistant, easy-to-clean stainless steel.

Set consisting of

Widening segment SP TITAN, pair	1251180
Widening segment RP TITAN, pair	1251201

TRUMPF

Medizin Systeme GmbH + Co. KG

Benzstrasse 26
82178 Puchheim
Germany
Telephone +49 (0) 89 / 8 09 07-0
Telefax +49 (0) 89 / 8 09 07-20
e-mail info@de.trumpf-med.com
www.trumpf-med.com

TRUMPF Medizin Systeme GmbH

Carl-Zeiss-Strasse 5
07318 Saalfeld
Germany
Telephone +49 (0) 36 71 / 5 86-0
Telefax +49 (0) 36 71 / 5 86-1 65
e-mail info@de.trumpf-med.com
www.trumpf-med.com

TRUMPF Medizin Systeme

Österreich GmbH

Industriepark 24
4061 Pasching
Austria
Telephone +43 (0) 72 21 / 6 03-1 50
Telefax +49 (0) 72 21 / 6 03-6 21
e-mail ulrich.mehrbrodt@at.trumpf-med.com
www.trumpf-med.com

TRUMPF AMSA SAS

146, Bd Charcot
BP 477
63013 Clermont-Ferrand cedex 1
France
Telephone +33 (0) 4 73 19 50 50
Telefax +33 (0) 4 73 37 29 31
e-mail trumpf-amsa@trumpf-amsa.com
www.fr.trumpf-med.com

TRUMPF Medical Systems Ltd.

The Granary Pinkney Park
Malmesbury · Wiltshire · SN16 0NX
Great Britain
Telephone +44 (0) 16 66 84 10 01
Telefax +44 (0) 16 66 84 10 08
e-mail info@uk.trumpf-med.com
www.uk.trumpf-med.com

TRUMPF MED ITALIA s.r.l.

Via C. Battisti, 31/C
35010 Limena – PD
Italy
Telephone +39 0 49 - 8 84 38 00
Telefax +39 0 49 - 8 84 11 24
e-mail areaclienti@it.trumpf-med.com
www.it.trumpf-med.com

TRUMPF Medical Systems, Inc.

415 Jessen Lane
Charleston, SC 29492
USA
Telephone +1 (843) 5 34 06 06
Telefax +1 (843) 5 34 02 06
e-mail info@us.trumpf-med.com
www.us.trumpf-med.com

TRUMPF Med Australia

Level 2, 52 Gibbes St
Chatswood Sydney NSW 2067
Australia
Telephone +61 2 94 06 89 00
Telefax +61 2 94 06 89 99
e-mail rick.wigham@trumpf-med.com.au
www.trumpf-med.com

TRUMPF

Medizin Systeme GmbH & Co. KG

3791 Jalan Bukit Merah #09-21
Singapore 159471
Telephone +65 62 72 - 78 68
Telefax +65 62 75 - 78 68
e-mail sales@sg.trumpf-med.com
www.sg.trumpf-med.com

TRUMPF Medical Systems Ltd.

Shanghai Representative Office
11H, Century Ba-Shi Building
398 Huai Hai Zhong Road
Shanghai 200020
P.R. China
Telephone +86 21 63 85 10 38
Telefax +86 21 63 85 16 60
e-mail info@cn.trumpf-med.com
www.trumpf-med.com

TRUMPF Medical Systems Dubai

Regional Office Middle East / Africa
B / P 49 Office Unit No. 201
Dubai Healthcare City
P.O. Box 505076
Dubai, UAE
Telephone +9 71 4 4 29 85 10
Telefax +9 71 4 4 29 85 08
e-mail info@ae.trumpf-med.com
www.trumpf-med.com